

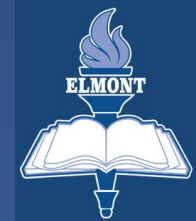

# Elmont Union Free School District – 2021 Bond Referendum And Budget Approved Projects Update Report, August 19, 2025



# Original Project Timeline, January 2021

- |   |                                 |
|---|---------------------------------|
| 1. Development of Projects, Cost Estimates, Timelines, Finance, Etc.  | January 2021 – September 2021   |
| 2. Bond Vote Passed by Taxpayers  | November 2021                   |
| 3. Architects Develop Security Booths Plans and Files with SED  | April 2022                      |
| 4. Architects Develop Plans for Remaining Bond Projects, Files with SED   | December 2021 – September 2022  |
| 5. State Education Department (SED) Approves Security Booth Plans   | October 3, 2022                 |
| 6. Security Booths and Cameras were Completed in all Six Schools  | March 2023                      |
| 7. State Education Department Approves Remaining Bond Projects  | June 2, 2023                    |
| 8. Bid Process for Bond Projects (Original Bids and Rebid for Mechanical, Plumbing)   | June 3, 2023 – September 2023   |
| 9. Board of Education Approves Bids and Contracts At Public Meeting   | October 16, 2023                |
| 10. Construction Manager, Principals, Administration Develop Construction Phasing Plans, Contractors submitted Bonds and Insurances, Attorney and Insurance Company Approve, District prepares areas for the first phase of Construction. | October 17, 2023 – January 2024 |
| 11. Start of Construction (Phase 1)   | January 22, 2024                |
| 12. Construction Period, Closeouts Documents  | January 2024 – March 2027       |

# BOND REFERENDUM, CAPITAL BUDGET PROJECTS ALL SCHOOLS

Description of Project	Impact	Status
NEW SECURITY ENTRANCES AND VIDEO CAMERA SYSTEMS	SCHOOL SAFETY	COMPLETED
NEW HEATING, VENTILATION, AND AIR-CONDITIONING SYSTEMS	HEALTH AND CODE COMPLIANCE	85% COMPLETED
NEW FIRE ALARM SYSTEMS	SAFETY AND CODE COMPLIANCE	65% COMPLETED
REMOVAL OF ASBESTOS CONTAINING MATERIALS	HEALTH AND SAFETY	85% COMPLETED
NEW LED LIGHTING	IMPROVE LEARNING ENVIRONMENT, ENERGY	90% COMPLETED
NEW CEILINGS, PAINTING, AND WALLBOARDS	IMPROVE LEARNING ENVIRONMENT	87% COMPLETED
NEW STUDENT RESTROOMS	HEALTH AND SAFETY AND ADA COMPLIANCE	COMPLETED

# Detailed Construction Progress Update

School Building	Total Number of Classrooms	Classrooms <b>90%</b> Completed as of 8.27.25
Alden Terrace	34	34 (100%)
Clara H. Carlson	47	39 (83%)
Covert Avenue	35	30 (85%)
Dutch Broadway	52	39 (75%)
Gotham Avenue	42	42 (100%)
Stewart Manor	21	21 (100%)
Gyms	6	6 (100%)
Cafeterias	6	6 (100%)
Libraries	6	6 (100%)
Offices	35	21 (60%)
<b>Totals</b>	<b>284</b>	<b>244 (86%) in 19 Months</b>

# DUTCH BROADWAY SCHOOL, FIRST FLOOR, ALL AREAS COMPLETED EXCEPT FOR MAIN LOBBY (In Yellow) AND REMOVAL OF HVAC EQUIPMENT

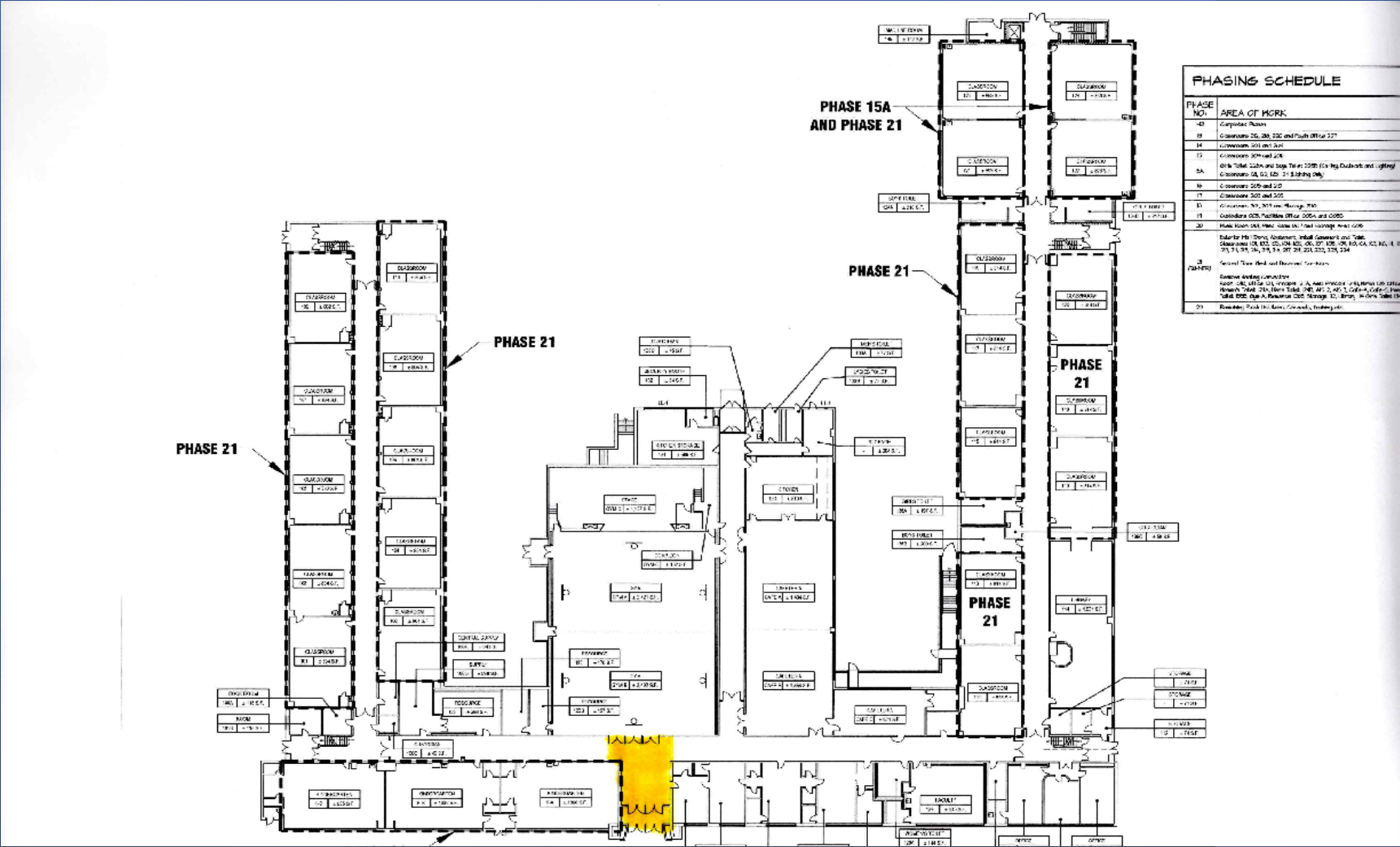







# CLARA H. CARLSON SCHOOL, SECOND FLOOR, AREAS NOT COMPLETED (In Yellow), WINDOW WALLS, REMOVAL OF HEATING SYSTEMS, NEW SHELVING (Green Line)

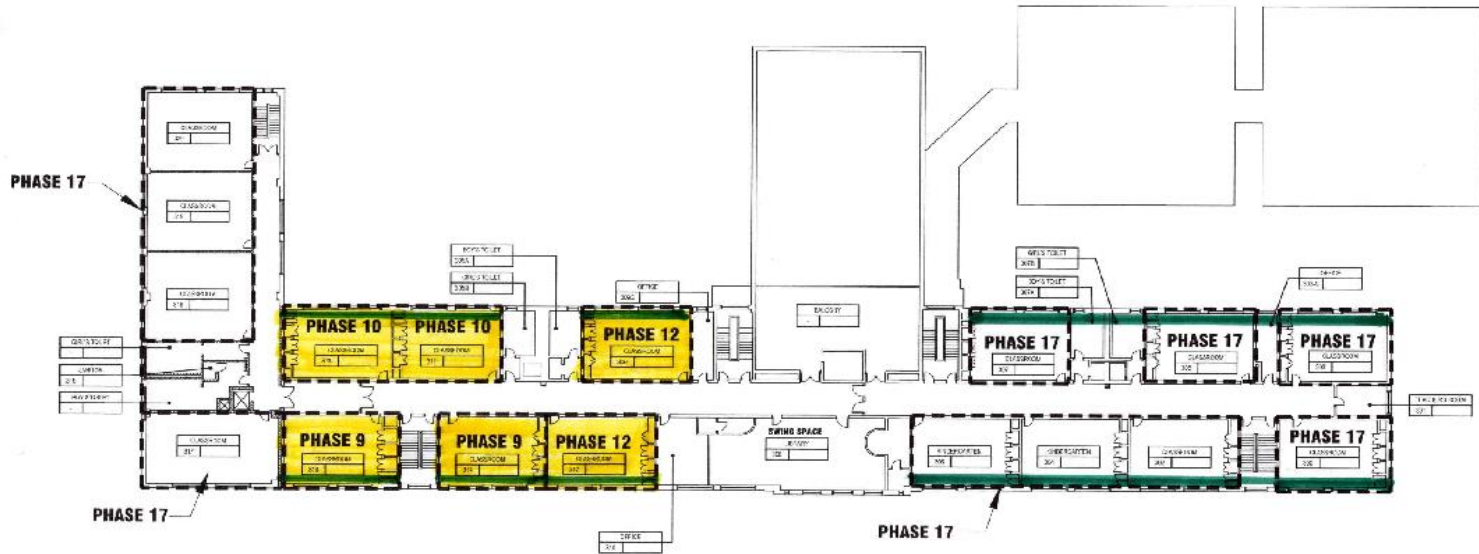

SECOND FLOOR PLAN  
PLAN: 116' x 110'

PHASE NO:	AREA OF WORK	START	FINISH	WEEKS
1	Completed Phase			
2	Classrooms 11 and 12	10/20/00	10/20/00	0
3	Classrooms 13 and 14	10/20/00	10/20/00	0
4	Main Room 15 and Art Room 16	10/20/00	10/20/00	0
5	Classrooms 17 and 18	10/20/00	10/20/00	0
6	Classrooms 19 through 20 and Cafeteria	10/20/00	10/20/00	0
7	Removal Room 21, Library 22, Office 23, Office 24 and Phase 8	10/20/00	10/20/00	0
8	Office 25, 26, 27, 28, 29, 30, 31, 32, 33, 34, 35, 36, 37, 38, 39, 40, 41, 42, 43, 44, 45, 46, 47, 48, 49, 50, 51, 52, 53, 54, 55, 56, 57, 58, 59, 60, 61, 62, 63, 64, 65, 66, 67, 68, 69, 70, 71, 72, 73, 74, 75, 76, 77, 78, 79, 80, 81, 82, 83, 84, 85, 86, 87, 88, 89, 90, 91, 92, 93, 94, 95, 96, 97, 98, 99, 100	10/20/00	10/20/00	0

NOTE:  
CONCRETE JOISTS ARE TO BE QUANTIFIED AND REINFORCED WITH STEEL DECKING AND SHEETPILE - SEE PLAN 117

# GOTHAM AVENUE SCHOOL, FIRST FLOOR, ALL ROOMS COMPLETED WINDOW WALLS, REMOVAL OF HEATING SYSTEMS, NEW SHELVING (Green Line)

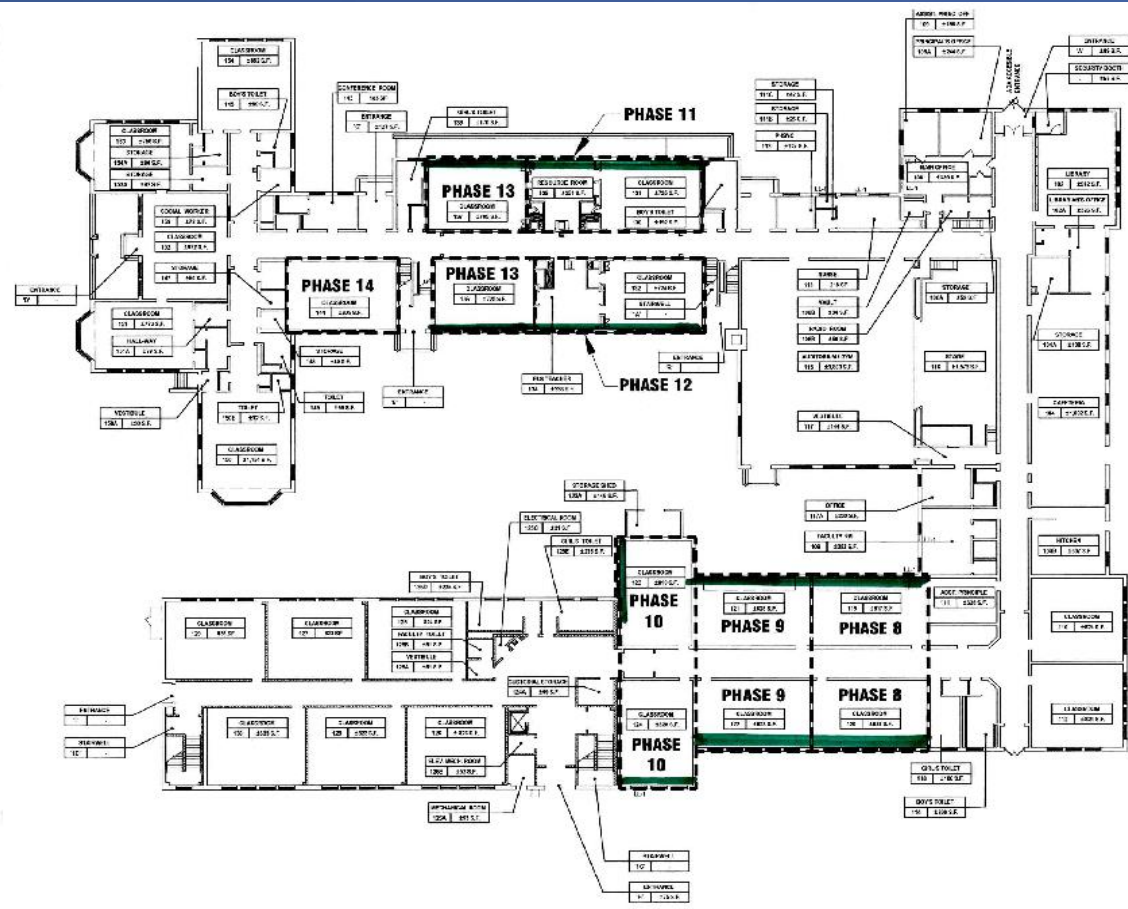

PHASE NO.	AREA OF WORK
11	Classroom 11
10	Classrooms 10 and 11 (Removal Heating, VAV, Install Windows)
9	Classrooms 10 and 11 (Remove Heating, VAV, Install Windows)
8	Classrooms 10 and 11 (Remove Heating, VAV, Install Windows)
7	Classrooms 10 and 11 (Remove Heating, VAV, Install Windows)
6	Classrooms 10 and 11 (Remove Heating, VAV, Install Windows)
5	Classrooms 10 and 11 (Remove Heating, VAV, Install Windows)
4	Classrooms 10 and 11 (Remove Heating, VAV, Install Windows)
3	Classrooms 10 and 11 (Remove Heating, VAV, Install Windows)
2	Classrooms 10 and 11 (Remove Heating, VAV, Install Windows)
1	Classrooms 10 and 11 (Remove Heating, VAV, Install Windows)

FIRST FLOOR PLAN  
SCALE: 1/8" = 1'-0"

# GOTHAM AVENUE SCHOOL, SECOND FLOOR, ALL ROOMS COMPLETED WINDOW WALLS, REMOVAL OF HEATING SYSTEMS, NEW SHELVING (Green Line)

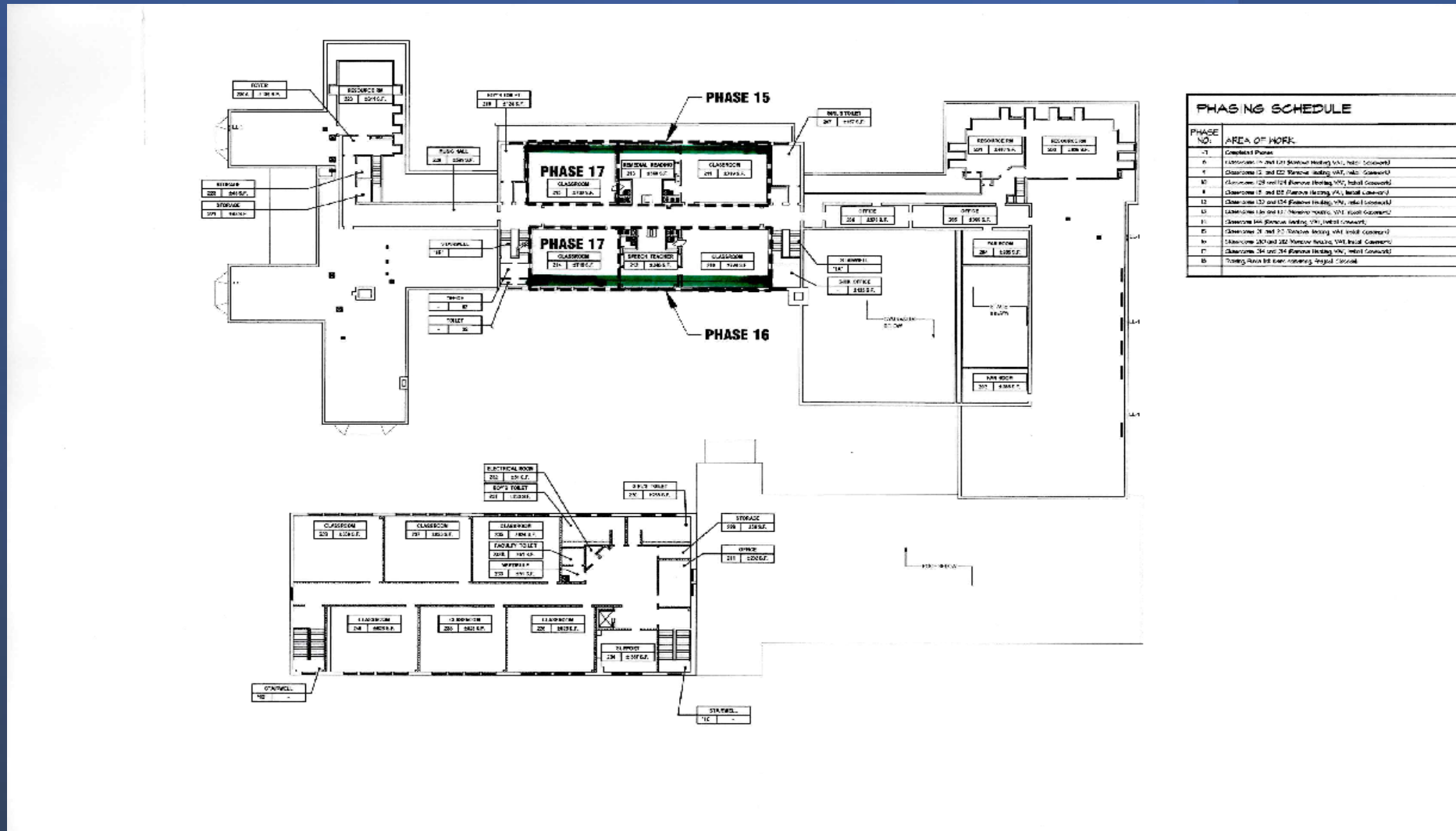

# STEWART MANOR SCHOOL, FIRST FLOOR, ALL AREAS COMPLETED WINDOW WALLS IN THREE CLASSROOMS, NEW SHELVING (Green Line)

PHASING SCHEDULE				
PHASE NO.	AREA OF WORK	START	FINISH	WEEKS
1	CONCRETE FOR FOUNDATION, EXTERIOR WALLS, ROOFING	07/15/00	08/15/00	1
2	FOUNDATION	08/15/00	09/15/00	1
3	CONCRETE	09/15/00	10/15/00	1
4	FOUNDATION	10/15/00	11/15/00	1
5	FOUNDATION	11/15/00	12/15/00	1
6	FOUNDATION	12/15/00	01/15/01	1
7	FOUNDATION	01/15/01	02/15/01	1
8	FOUNDATION	02/15/01	03/15/01	1
9	FOUNDATION	03/15/01	04/15/01	1
10	FOUNDATION	04/15/01	05/15/01	1
11	FOUNDATION	05/15/01	06/15/01	1
12	FOUNDATION	06/15/01	07/15/01	1

NOTE:  
 1. ALL WORK IS TO BE COMPLETED BY THE DATE SHOWN.  
 2. ALL WORK IS TO BE COMPLETED BY THE DATE SHOWN.

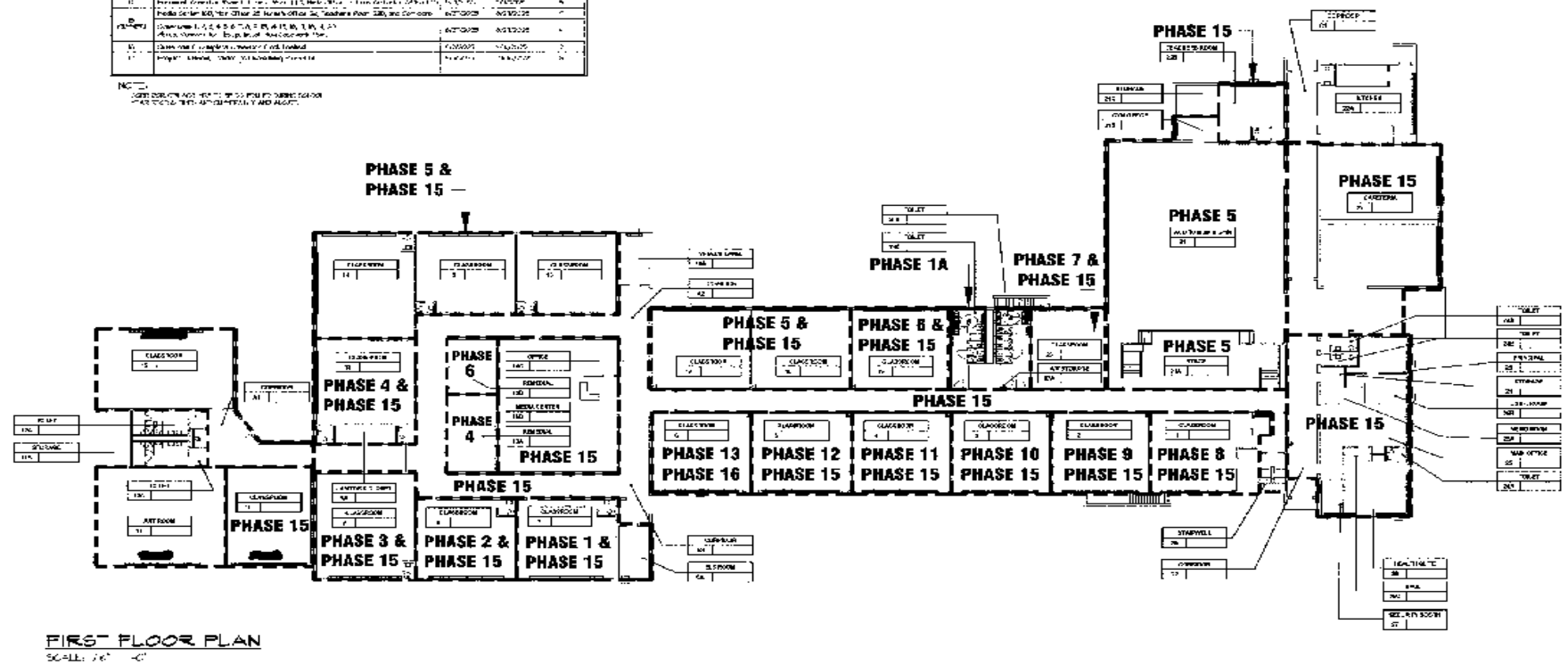

FIRST FLOOR PLAN  
 SCALE: 1/4" = 1'-0"

# ALDEN TERRACE SCHOOL, FIRST FLOOR, ALL AREAS COMPLETED WINDOW WALLS, REMOVAL OF HEATING SYSTEMS, NEW SHELVING (In Green)

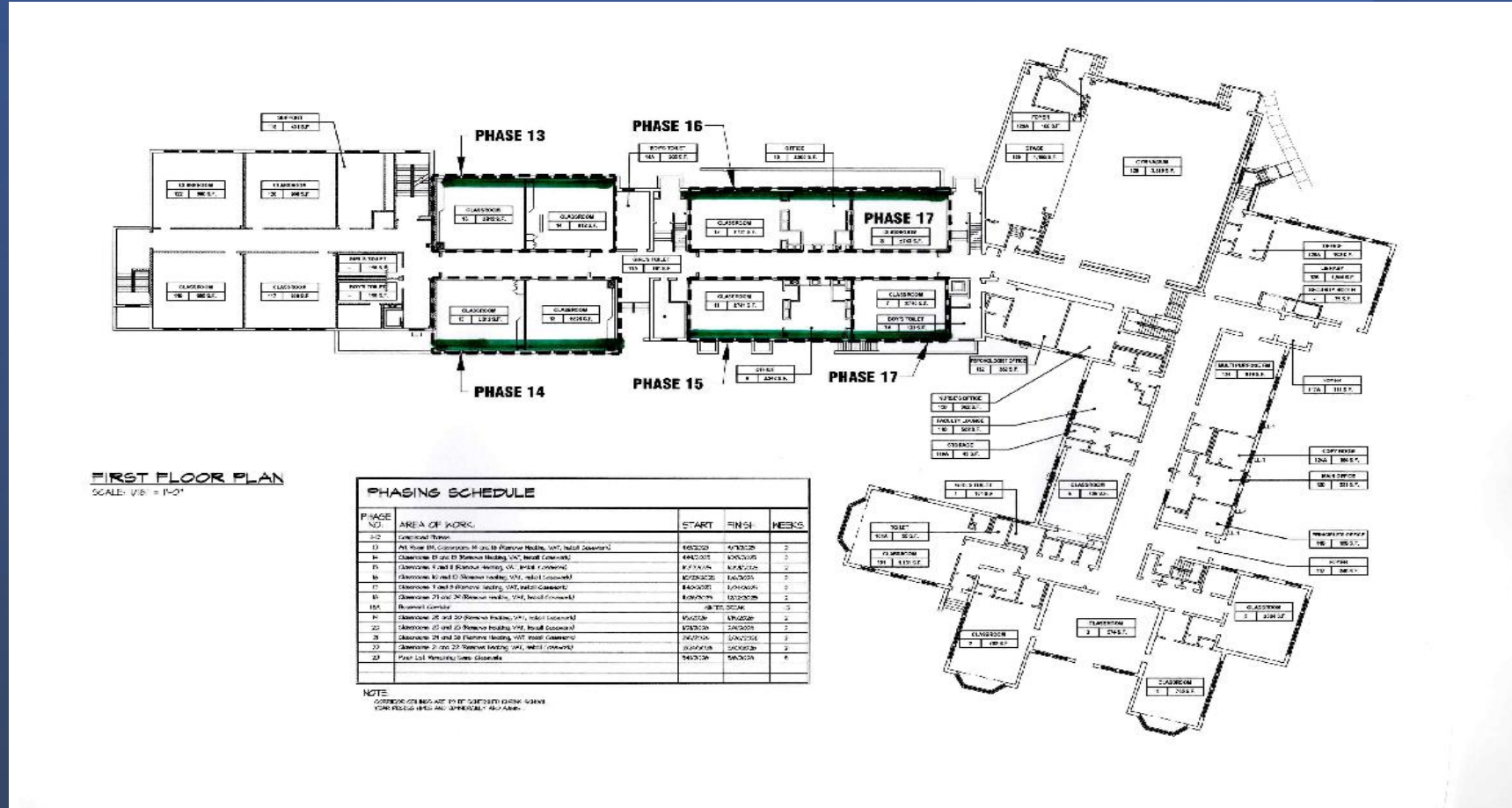



# COVERT AVENUE SCHOOL, LOWER LEVEL, AREAS NOT COMPLETED (IN YELLOW)

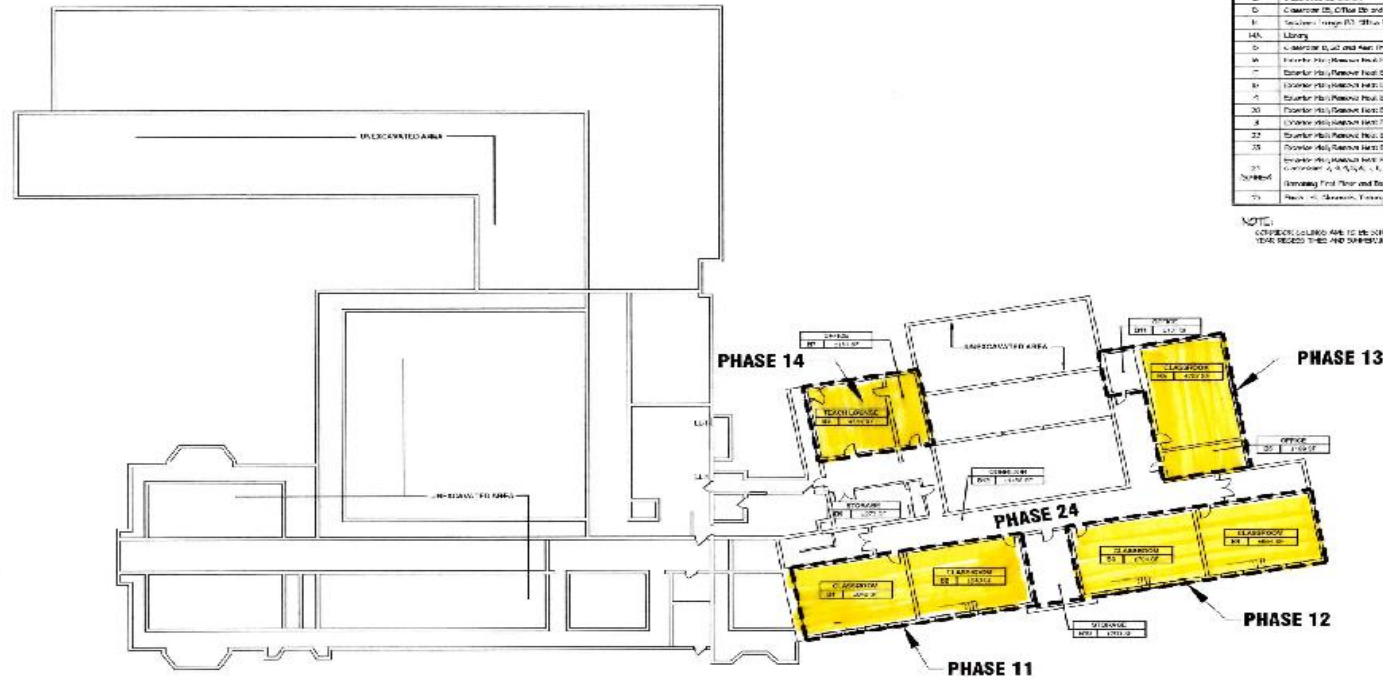

LOWER LEVEL PLAN  
SCALE: 1/8" = 1'-0"

PHASING SCHEDULE	
PHASE NO.	AREA OF WORK
1-10	Completed Phases
11	Classroom 11 and 12
12	Classroom 12 and 13
13	Classroom 13, Office 13 and 14
14	Classroom 14, Office 15, Office 16 and Office 17
15	Classroom 15 and 16
16	Classroom 16, 17 and 18
17	Classroom 17, 18 and 19
18	Classroom 18, 19 and 20
19	Classroom 19, 20 and 21
20	Classroom 20, 21 and 22
21	Classroom 21, 22 and 23
22	Classroom 22, 23 and 24
23	Classroom 23, 24 and 25
24	Classroom 24, 25 and 26
25	Classroom 25, 26 and 27
26	Classroom 26, 27 and 28
27	Classroom 27, 28 and 29
28	Classroom 28, 29 and 30
29	Classroom 29, 30 and 31
30	Classroom 30, 31 and 32
31	Classroom 31, 32 and 33
32	Classroom 32, 33 and 34
33	Classroom 33, 34 and 35
34	Classroom 34, 35 and 36
35	Classroom 35, 36 and 37
36	Classroom 36, 37 and 38
37	Classroom 37, 38 and 39
38	Classroom 38, 39 and 40
39	Classroom 39, 40 and 41
40	Classroom 40, 41 and 42
41	Classroom 41, 42 and 43
42	Classroom 42, 43 and 44
43	Classroom 43, 44 and 45
44	Classroom 44, 45 and 46
45	Classroom 45, 46 and 47
46	Classroom 46, 47 and 48
47	Classroom 47, 48 and 49
48	Classroom 48, 49 and 50
49	Classroom 49, 50 and 51
50	Classroom 50, 51 and 52
51	Classroom 51, 52 and 53
52	Classroom 52, 53 and 54
53	Classroom 53, 54 and 55
54	Classroom 54, 55 and 56
55	Classroom 55, 56 and 57
56	Classroom 56, 57 and 58
57	Classroom 57, 58 and 59
58	Classroom 58, 59 and 60
59	Classroom 59, 60 and 61
60	Classroom 60, 61 and 62
61	Classroom 61, 62 and 63
62	Classroom 62, 63 and 64
63	Classroom 63, 64 and 65
64	Classroom 64, 65 and 66
65	Classroom 65, 66 and 67
66	Classroom 66, 67 and 68
67	Classroom 67, 68 and 69
68	Classroom 68, 69 and 70
69	Classroom 69, 70 and 71
70	Classroom 70, 71 and 72
71	Classroom 71, 72 and 73
72	Classroom 72, 73 and 74
73	Classroom 73, 74 and 75
74	Classroom 74, 75 and 76
75	Classroom 75, 76 and 77
76	Classroom 76, 77 and 78
77	Classroom 77, 78 and 79
78	Classroom 78, 79 and 80
79	Classroom 79, 80 and 81
80	Classroom 80, 81 and 82
81	Classroom 81, 82 and 83
82	Classroom 82, 83 and 84
83	Classroom 83, 84 and 85
84	Classroom 84, 85 and 86
85	Classroom 85, 86 and 87
86	Classroom 86, 87 and 88
87	Classroom 87, 88 and 89
88	Classroom 88, 89 and 90
89	Classroom 89, 90 and 91
90	Classroom 90, 91 and 92
91	Classroom 91, 92 and 93
92	Classroom 92, 93 and 94
93	Classroom 93, 94 and 95
94	Classroom 94, 95 and 96
95	Classroom 95, 96 and 97
96	Classroom 96, 97 and 98
97	Classroom 97, 98 and 99
98	Classroom 98, 99 and 100
99	Classroom 99, 100 and 101
100	Classroom 100, 101 and 102
101	Classroom 101, 102 and 103
102	Classroom 102, 103 and 104
103	Classroom 103, 104 and 105
104	Classroom 104, 105 and 106
105	Classroom 105, 106 and 107
106	Classroom 106, 107 and 108
107	Classroom 107, 108 and 109
108	Classroom 108, 109 and 110
109	Classroom 109, 110 and 111
110	Classroom 110, 111 and 112
111	Classroom 111, 112 and 113
112	Classroom 112, 113 and 114
113	Classroom 113, 114 and 115
114	Classroom 114, 115 and 116
115	Classroom 115, 116 and 117
116	Classroom 116, 117 and 118
117	Classroom 117, 118 and 119
118	Classroom 118, 119 and 120
119	Classroom 119, 120 and 121
120	Classroom 120, 121 and 122
121	Classroom 121, 122 and 123
122	Classroom 122, 123 and 124
123	Classroom 123, 124 and 125
124	Classroom 124, 125 and 126
125	Classroom 125, 126 and 127
126	Classroom 126, 127 and 128
127	Classroom 127, 128 and 129
128	Classroom 128, 129 and 130
129	Classroom 129, 130 and 131
130	Classroom 130, 131 and 132
131	Classroom 131, 132 and 133
132	Classroom 132, 133 and 134
133	Classroom 133, 134 and 135
134	Classroom 134, 135 and 136
135	Classroom 135, 136 and 137
136	Classroom 136, 137 and 138
137	Classroom 137, 138 and 139
138	Classroom 138, 139 and 140
139	Classroom 139, 140 and 141
140	Classroom 140, 141 and 142
141	Classroom 141, 142 and 143
142	Classroom 142, 143 and 144
143	Classroom 143, 144 and 145
144	Classroom 144, 145 and 146
145	Classroom 145, 146 and 147
146	Classroom 146, 147 and 148
147	Classroom 147, 148 and 149
148	Classroom 148, 149 and 150
149	Classroom 149, 150 and 151
150	Classroom 150, 151 and 152
151	Classroom 151, 152 and 153
152	Classroom 152, 153 and 154
153	Classroom 153, 154 and 155
154	Classroom 154, 155 and 156
155	Classroom 155, 156 and 157
156	Classroom 156, 157 and 158
157	Classroom 157, 158 and 159
158	Classroom 158, 159 and 160
159	Classroom 159, 160 and 161
160	Classroom 160, 161 and 162
161	Classroom 161, 162 and 163
162	Classroom 162, 163 and 164
163	Classroom 163, 164 and 165
164	Classroom 164, 165 and 166
165	Classroom 165, 166 and 167
166	Classroom 166, 167 and 168
167	Classroom 167, 168 and 169
168	Classroom 168, 169 and 170
169	Classroom 169, 170 and 171
170	Classroom 170, 171 and 172
171	Classroom 171, 172 and 173
172	Classroom 172, 173 and 174
173	Classroom 173, 174 and 175
174	Classroom 174, 175 and 176
175	Classroom 175, 176 and 177
176	Classroom 176, 177 and 178
177	Classroom 177, 178 and 179
178	Classroom 178, 179 and 180
179	Classroom 179, 180 and 181
180	Classroom 180, 181 and 182
181	Classroom 181, 182 and 183
182	Classroom 182, 183 and 184
183	Classroom 183, 184 and 185
184	Classroom 184, 185 and 186
185	Classroom 185, 186 and 187
186	Classroom 186, 187 and 188
187	Classroom 187, 188 and 189
188	Classroom 188, 189 and 190
189	Classroom 189, 190 and 191
190	Classroom 190, 191 and 192
191	Classroom 191, 192 and 193
192	Classroom 192, 193 and 194
193	Classroom 193, 194 and 195
194	Classroom 194, 195 and 196
195	Classroom 195, 196 and 197
196	Classroom 196, 197 and 198
197	Classroom 197, 198 and 199
198	Classroom 198, 199 and 200
199	Classroom 199, 200 and 201
200	Classroom 200, 201 and 202
201	Classroom 201, 202 and 203
202	Classroom 202, 203 and 204
203	Classroom 203, 204 and 205
204	Classroom 204, 205 and 206
205	Classroom 205, 206 and 207
206	Classroom 206, 207 and 208
207	Classroom 207, 208 and 209
208	Classroom 208, 209 and 210
209	Classroom 209, 210 and 211
210	Classroom 210, 211 and 212
211	Classroom 211, 212 and 213
212	Classroom 212, 213 and 214
213	Classroom 213, 214 and 215
214	Classroom 214, 215 and 216
215	Classroom 215, 216 and 217
216	Classroom 216, 217 and 218
217	Classroom 217, 218 and 219
218	Classroom 218, 219 and 220
219	Classroom 219, 220 and 221
220	Classroom 220, 221 and 222
221	Classroom 221, 222 and 223
222	Classroom 222, 223 and 224
223	Classroom 223, 224 and 225
224	Classroom 224, 225 and 226
225	Classroom 225, 226 and 227
226	Classroom 226, 227 and 228
227	Classroom 227, 228 and 229
228	Classroom 228, 229 and 230
229	Classroom 229, 230 and 231
230	Classroom 230, 231 and 232
231	Classroom 231, 232 and 233
232	Classroom 232, 233 and 234
233	Classroom 233, 234 and 235
234	Classroom 234, 235 and 236
235	Classroom 235, 236 and 237
236	Classroom 236, 237 and 238
237	Classroom 237, 238 and 239
238	Classroom 238, 239 and 240
239	Classroom 239, 240 and 241
240	Classroom 240, 241 and 242
241	Classroom 241, 242 and 243
242	Classroom 242, 243 and 244
243	Classroom 243, 244 and 245
244	Classroom 244, 245 and 246
245	Classroom 245, 246 and 247
246	Classroom 246, 247 and 248
247	Classroom 247, 248 and 249
248	Classroom 248, 249 and 250
249	Classroom 249, 250 and 251
250	Classroom 250, 251 and 252
251	Classroom 251, 252 and 253
252	Classroom 252, 253 and 254
253	Classroom 253, 254 and 255
254	Classroom 254, 255 and 256
255	Classroom 255, 256 and 257
256	Classroom 256, 257 and 258
257	Classroom 257, 258 and 259
258	Classroom 258, 259 and 260
259	Classroom 259, 260 and 261
260	Classroom 260, 261 and 262
261	Classroom 261, 262 and 263
262	Classroom 262, 263 and 264
263	Classroom 263, 264 and 265
264	Classroom 264, 265 and 266
265	Classroom 265, 266 and 267
266	Classroom 266, 267 and 268
267	Classroom 267, 268 and 269
268	Classroom 268, 269 and 270
269	Classroom 269, 270 and 271
270	Classroom 270, 271 and 272
271	Classroom 271, 272 and 273
272	Classroom 272, 273 and 274
273	Classroom 273, 274 and 275
274	Classroom 274, 275 and 276
275	Classroom 275, 276 and 277
276	Classroom 276, 277 and 278
277	Classroom 277, 278 and 279
278	Classroom 278, 279 and 280
279	Classroom 279, 280 and 281
280	Classroom 280, 281 and 282
281	Classroom 281, 282 and 283
282	Classroom 282, 283 and 284
283	Classroom 283, 284 and 285
284	Classroom 284, 285 and 286
285	Classroom 285, 286 and 287
286	Classroom 286, 287 and 288
287	Classroom 287, 288 and 289
288	Classroom 288, 289 and 290
289	Classroom 289, 290 and 291
290	Classroom 290, 291 and 292
291	Classroom 291, 292 and 293
292	Classroom 292, 293 and 294
293	Classroom 293, 294 and 295
294	Classroom 294, 295 and 296
295	Classroom 295, 296 and 297
296	Classroom 296, 297 and 298
297	Classroom 297, 298 and 299
298	Classroom 298, 299 and 300
299	Classroom 299, 300 and 301
300	Classroom 300, 301 and 302
301	Classroom 301, 302 and 303
302	Classroom 302, 303 and 304
303	Classroom 303, 304 and 305
304	Classroom 304, 305 and 306
305	Classroom 305, 306 and 307
306	Classroom 306, 307 and 308
307	Classroom 307, 308 and 309
308	Classroom 308, 309 and 310
309	Classroom 309, 310 and 311
310	Classroom 310, 311 and 312
311	Classroom 311, 312 and 313
312	Classroom 312, 313 and 314
313	Classroom 313, 314 and 315
314	Classroom 314, 315 and 316
315	Classroom 315, 316 and 317
316	Classroom 316, 317 and 318
317	Classroom 317, 318 and 319
318	Classroom 318, 319 and 320
319	Classroom 319, 320 and 321
320	Classroom 320, 321 and 322
321	Classroom 321, 322 and 323
322	Classroom 322, 323 and 324
323	Classroom 323, 324 and 325
324	Classroom 324, 325 and 326
325	Classroom 325, 326 and 327
326	Classroom 326, 327 and 328
327	Classroom 327, 328 and 329
328	Classroom 328, 329 and 330
329	Classroom 329, 330 and 331
330	Classroom 330, 331 and 332
331	Classroom 331, 332 and 333
332	Classroom 332, 333 and 334
333	Classroom 333, 33

# COVERT AVENUE SCHOOL, FIRST FLOOR, AREAS NOT COMPLETED (IN YELLOW) WINDOW WALLS, REMOVAL OF HEATING SYSTEMS, NEW SHELVING (In Green)

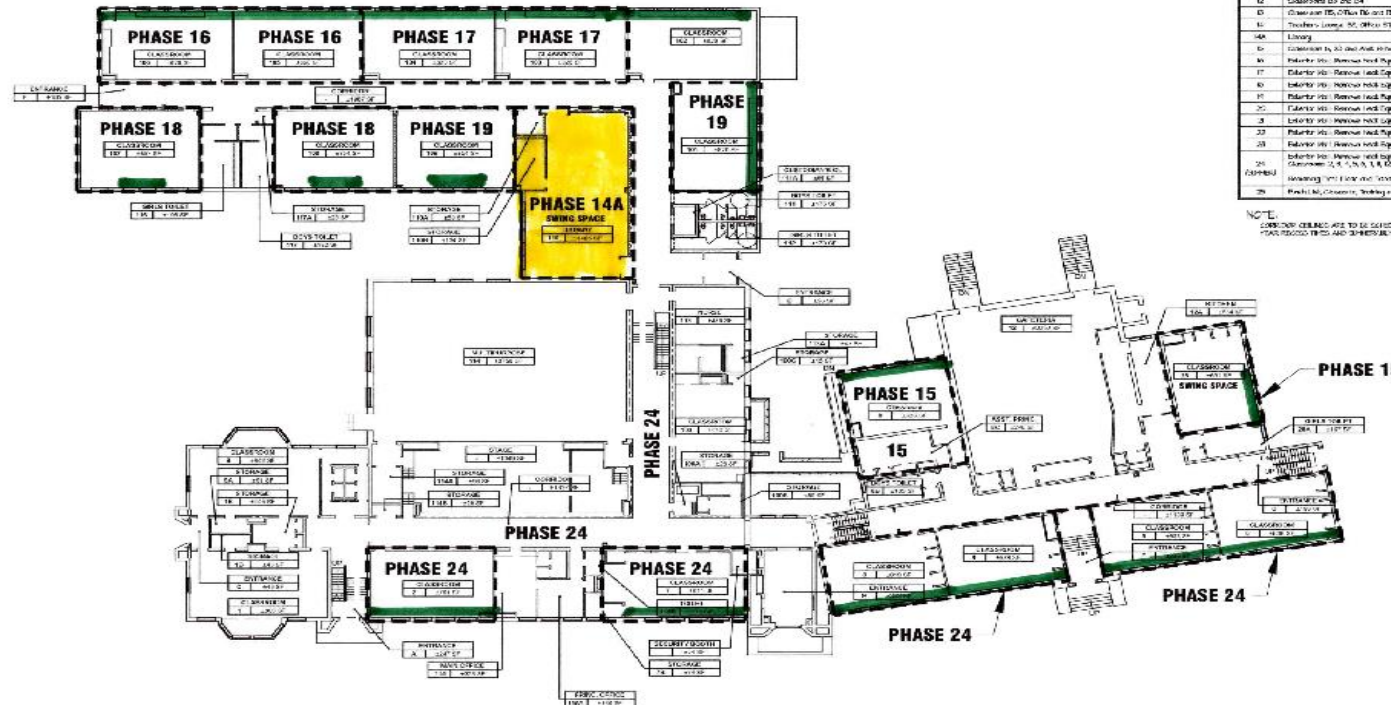

PHASE NO	AREA OF WORK
1-10	Completed Phases
11	Classrooms 101 and 102
12	Classrooms 103 and 104
13	Classroom 105, Room 106 and 107
14	Teacher's Lounge, Art Office, PE and Office 102
14A	Library
15	Classroom 108, 109 and 110
16	Classroom 111, Remove Heat Sigs, Install Ceiling, Room, Classroom 111 and 112
17	Classroom 113, Remove Heat Sigs, Install Ceiling, Paint Classroom 100 and 104
18	Classroom 114, Remove Heat Sigs, Install Ceiling, Paint Classroom 101 and 103
19	Classroom 115, Remove Heat Sigs, Install Ceiling, Paint Classroom 105 and 107
20	Classroom 116, Remove Heat Sigs, Install Ceiling, Paint Classroom 118 and 119
21	Classroom 117, Remove Heat Sigs, Install Ceiling, Paint Classroom 110 and 111
22	Classroom 118, Remove Heat Sigs, Install Ceiling, Paint Classroom 112 and 114
23	Classroom 119, Remove Heat Sigs, Install Ceiling, Paint Classroom 113 and 115
24	Classroom 120, 121, 122, 123, 124, 125, 126, 127, 128, 129, 130, 131, 132, 133, 134, 135, 136, 137, 138, 139, 140, 141, 142, 143, 144, 145, 146, 147, 148, 149, 150, 151, 152, 153, 154, 155, 156, 157, 158, 159, 160, 161, 162, 163, 164, 165, 166, 167, 168, 169, 170, 171, 172, 173, 174, 175, 176, 177, 178, 179, 180, 181, 182, 183, 184, 185, 186, 187, 188, 189, 190, 191, 192, 193, 194, 195, 196, 197, 198, 199, 200, 201, 202, 203, 204, 205, 206, 207, 208, 209, 210, 211, 212, 213, 214, 215, 216, 217, 218, 219, 220, 221, 222, 223, 224, 225, 226, 227, 228, 229, 230, 231, 232, 233, 234, 235, 236, 237, 238, 239, 240, 241, 242, 243, 244, 245, 246, 247, 248, 249, 250, 251, 252, 253, 254, 255, 256, 257, 258, 259, 260, 261, 262, 263, 264, 265, 266, 267, 268, 269, 270, 271, 272, 273, 274, 275, 276, 277, 278, 279, 280, 281, 282, 283, 284, 285, 286, 287, 288, 289, 290, 291, 292, 293, 294, 295, 296, 297, 298, 299, 300, 301, 302, 303, 304, 305, 306, 307, 308, 309, 310, 311, 312, 313, 314, 315, 316, 317, 318, 319, 320, 321, 322, 323, 324, 325, 326, 327, 328, 329, 330, 331, 332, 333, 334, 335, 336, 337, 338, 339, 340, 341, 342, 343, 344, 345, 346, 347, 348, 349, 350, 351, 352, 353, 354, 355, 356, 357, 358, 359, 360, 361, 362, 363, 364, 365, 366, 367, 368, 369, 370, 371, 372, 373, 374, 375, 376, 377, 378, 379, 380, 381, 382, 383, 384, 385, 386, 387, 388, 389, 390, 391, 392, 393, 394, 395, 396, 397, 398, 399, 400, 401, 402, 403, 404, 405, 406, 407, 408, 409, 410, 411, 412, 413, 414, 415, 416, 417, 418, 419, 420, 421, 422, 423, 424, 425, 426, 427, 428, 429, 430, 431, 432, 433, 434, 435, 436, 437, 438, 439, 440, 441, 442, 443, 444, 445, 446, 447, 448, 449, 450, 451, 452, 453, 454, 455, 456, 457, 458, 459, 460, 461, 462, 463, 464, 465, 466, 467, 468, 469, 470, 471, 472, 473, 474, 475, 476, 477, 478, 479, 480, 481, 482, 483, 484, 485, 486, 487, 488, 489, 490, 491, 492, 493, 494, 495, 496, 497, 498, 499, 500, 501, 502, 503, 504, 505, 506, 507, 508, 509, 510, 511, 512, 513, 514, 515, 516, 517, 518, 519, 520, 521, 522, 523, 524, 525, 526, 527, 528, 529, 530, 531, 532, 533, 534, 535, 536, 537, 538, 539, 540, 541, 542, 543, 544, 545, 546, 547, 548, 549, 550, 551, 552, 553, 554, 555, 556, 557, 558, 559, 560, 561, 562, 563, 564, 565, 566, 567, 568, 569, 570, 571, 572, 573, 574, 575, 576, 577, 578, 579, 580, 581, 582, 583, 584, 585, 586, 587, 588, 589, 590, 591, 592, 593, 594, 595, 596, 597, 598, 599, 600, 601, 602, 603, 604, 605, 606, 607, 608, 609, 610, 611, 612, 613, 614, 615, 616, 617, 618, 619, 620, 621, 622, 623, 624, 625, 626, 627, 628, 629, 630, 631, 632, 633, 634, 635, 636, 637, 638, 639, 640, 641, 642, 643, 644, 645, 646, 647, 648, 649, 650, 651, 652, 653, 654, 655, 656, 657, 658, 659, 660, 661, 662, 663, 664, 665, 666, 667, 668, 669, 670, 671, 672, 673, 674, 675, 676, 677, 678, 679, 680, 681, 682, 683, 684, 685, 686, 687, 688, 689, 690, 691, 692, 693, 694, 695, 696, 697, 698, 699, 700, 701, 702, 703, 704, 705, 706, 707, 708, 709, 710, 711, 712, 713, 714, 715, 716, 717, 718, 719, 720, 721, 722, 723, 724, 725, 726, 727, 728, 729, 730, 731, 732, 733, 734, 735, 736, 737, 738, 739, 740, 741, 742, 743, 744, 745, 746, 747, 748, 749, 750, 751, 752, 753, 754, 755, 756, 757, 758, 759, 760, 761, 762, 763, 764, 765, 766, 767, 768, 769, 770, 771, 772, 773, 774, 775, 776, 777, 778, 779, 780, 781, 782, 783, 784, 785, 786, 787, 788, 789, 790, 791, 792, 793, 794, 795, 796, 797, 798, 799, 800, 801, 802, 803, 804, 805, 806, 807, 808, 809, 810, 811, 812, 813, 814, 815, 816, 817, 818, 819, 820, 821, 822, 823, 824, 825, 826, 827, 828, 829, 830, 831, 832, 833, 834, 835, 836, 837, 838, 839, 840, 841, 842, 843, 844, 845, 846, 847, 848, 849, 850, 851, 852, 853, 854, 855, 856, 857, 858, 859, 860, 861, 862, 863, 864, 865, 866, 867, 868, 869, 870, 871, 872, 873, 874, 875, 876, 877, 878, 879, 880, 881, 882, 883, 884, 885, 886, 887, 888, 889, 890, 891, 892, 893, 894, 895, 896, 897, 898, 899, 900, 901, 902, 903, 904, 905, 906, 907, 908, 909, 910, 911, 912, 913, 914, 915, 916, 917, 918, 919, 920, 921, 922, 923, 924, 925, 926, 927, 928, 929, 930, 931, 932, 933, 934, 935, 936, 937, 938, 939, 940, 941, 942, 943, 944, 945, 946, 947, 948, 949, 950, 951, 952, 953, 954, 955, 956, 957, 958, 959, 960, 961, 962, 963, 964, 965, 966, 967, 968, 969, 970, 971, 972, 973, 974, 975, 976, 977, 978, 979, 980, 981, 982, 983, 984, 985, 986, 987, 988, 989, 990, 991, 992, 993, 994, 995, 996, 997, 998, 999, 1000

NOTE:  
CONSTRUCTION SHALL BE CONFINED TO THE SCHOOL.  
TRAFFIC TO BE KEPT TO THE MINIMUM AND AVOID.

FIRST FLOOR PLAN  
SCALE: 1/8" = 1'-0"



# Current Awarded Capital Projects, Financial Position

<b>FUNDING SOURCES</b>	<b>FUNDING AMOUNTS APPROVED BY TAXPAYERS</b>	<b>STATE AID (OVER 15 YEARS)</b>
2021 Bond Referendum	\$52,000,000	\$37,076,000
Annual School Budget Authorizations	\$9,765,352	\$6,962,696
Total Funds Approved by Taxpayers	\$61,765,352	\$44,038,696 \$2,935,913 +/- Annually

## UPDATE: STATUS AS OF 8/18/2025

<b>Expenditures to Date</b>	<b>\$46,318,751 (75%)</b>
<b>Costs Above Taxpayer-Approved Funds and Total Approved Contracts to Date</b>	<b>\$ NONE</b>

# ALDEN TERRACE CONSTRUCTION PROGRESS



**New Dedicated Outdoor Air System Ductwork**



**New HVAC Equipment**



**New Classroom Ceilings and Lighting**

**New Office Ceilings and Lighting**

# CLARA H. CARLSON CONSTRUCTION PROGRESS



ALL CORRIDOR CEILINGS BEING REPLACED

DUCTWORK IN GYM

SHAFTS FROM BASEMENT TO ROOF



CORRIDOR HVAC PIPING

DUCTWORK IN SHAFTS

SCAFFOLDING IN AUDITORIUM FOR HVAC



CORRIDOR HVAC PIPING

CLASSROOM AND OFFICE DUCTWORK, CEILINGS, LIGHTING

# COVERT AVENUE CONSTRUCTION PROGRESS



**NEW DEDICATED OUTDOOR AIR SYSTEMS DUCTWORK**



**ROOFTOP ELECTRICAL PIPING AND ROOF CURBS FOR NEW HVAC SYSTEMS**



**Cafeteria HVAC**

**VRF CASSETTES IN CLASSROOMS**

**OLD CLASSROOM LIGHTING**

**NEW LIGHTING**

# DUTCH BROADWAY CONSTRUCTION PROGRESS



**CORRIDOR CEILINGS REMOVED AND REPLACED**



**NEW DEDICATED OUTDOOR AIR SYSTEM (DOAS) DUCTWORK**



**NEW CEILINGS AND LIGHTING IN CORRIDORS, LIBRARY, CLASSROOMS, AND OFFICES**

# GOTHAM AVENUE CONSTRUCTION PROGRESS



**CORRIDOR CEILINGS REMOVED AND REPLACED**



**NEW WALLS**

**OFFICE DUCTWORK**

**GYM CEILING REPLACEMENT**

**ELECTRICAL PIPING**



**CAFETERIA, NEW CEILINGS, LIGHTING, HVAC**

**NEW OFFICE**

**CORRIDOR CEILING**

# STEWART MANOR CONSTRUCTION PROGRESS



**CLASSROOMS, CORRIDORS UNDER CONSTRUCTION**



**NEW CLASSROOM FLOORS**

**NEW CEILINGS, LIGHTING, AND FIRE ALARM DEVICES IN CLASSROOMS AND OFFICES**



**NEW CORRIDOR CEILINGS AND LIGHTING**

## STEWART MANOR NEW PLAYGROUND PICTURES



# Clara H. Carlson School New Playground Construction Pictures



## Alden Terrace School Playground Construction



# THANK YOU!



## ANY QUESTIONS OR COMMENTS?

Next Bond Update  
December 2025